

**THERMACUT® REPLACEMENT PARTS SUITABLE FOR**  
**Hypertherm®**  
**MAX®40**  
**PAC®140/M**

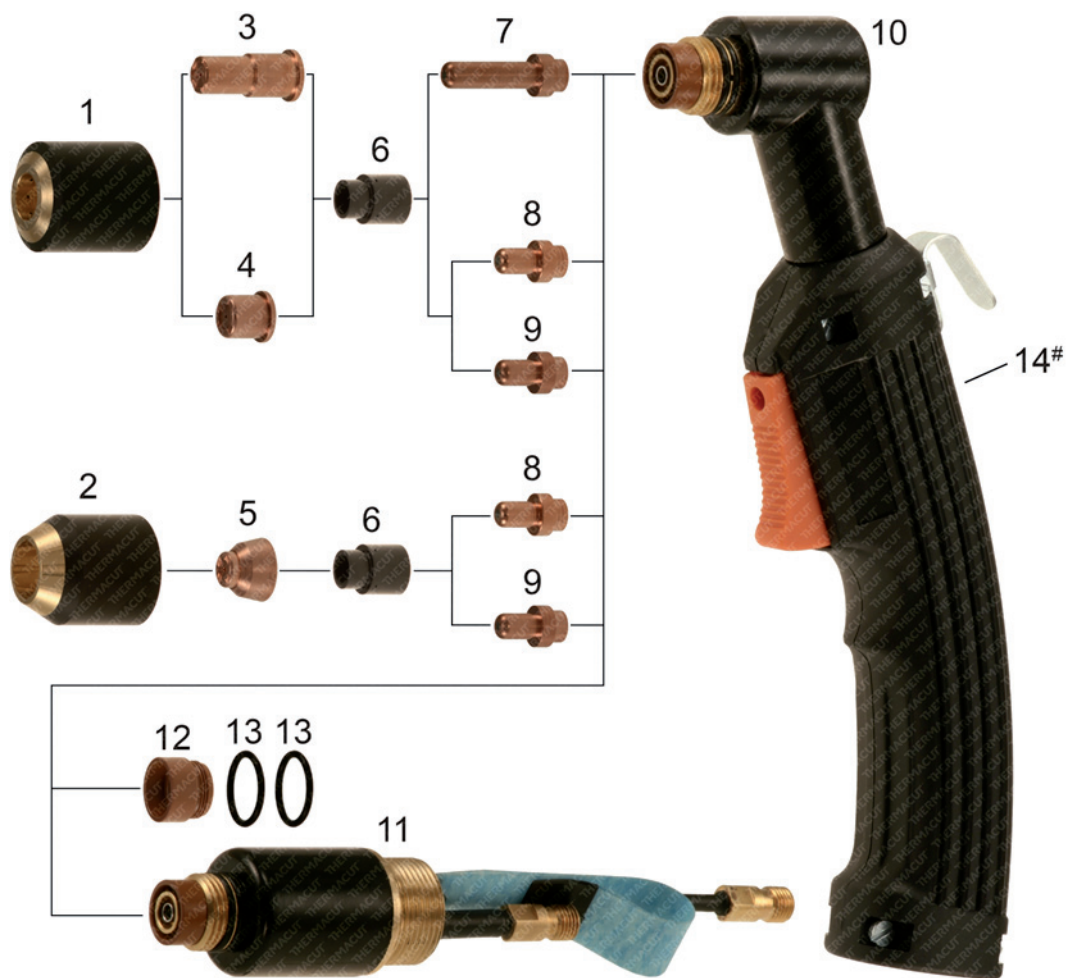

Item	Part No.	Ref. No.	Description	Std. Pkg.	Item	Part No.	Ref. No.	Description	Std. Pkg.
1.	T-0043	020104	Retaining Cap, Standard	1	10,14.	T-0055	020122	PAC®140 Hand Torch + Handle	1
2.	T-0044	020200	Retaining Cap, Tapered	1	11.	T-0056	020114	PAC®140/M Machine Torch	1
3.	T-0050	020466	Nozzle, Extended	10	12.	T-0095	020114-1	Front Insulator	1
4.	T-0045	020115	Nozzle 40A	10	13.	T-0038	044016	O-Ring	1
	T-0046	020102	Nozzle 40A (HT®40)	10	#14.	T-1040#	9-5636-1	Handle	5
5.	T-0048	020197	Nozzle 40A, Tapered	10	NS	KT-1229	K.PAC140H.5M	PAC®140/H Hand Torch with Lead 5m (16')	1
NS	T-0096	020340	Nozzle, Gouging	10	NS	KT-1210	057112	PAC®140/H Hand Torch with Lead 7.6m (25')	1
NS	T-0047	020131	Nozzle, Pipe Saddle (HT®40)	10	NS	KT-1261	057113	PAC®140/H Hand Torch with Lead 15.2m (50')	1
6.	T-0051	020101	Swirl Ring	2	NS	KT-1084	028290	PAC®140/M Cable Leads, Mach. 15.2m (50')	1
7.	T-0054	020467	Electrode, Extended	5	Different types of cable leads available on request				
8.	T-0053	020167	Electrode, N <sub>2</sub>	10					
9.	T-0052	020103	Electrode, Air	10					

# ONLY FOR THERMACUT TORCH DESIGN

NS NOT SHOWN IN THE PICTURE

MAX®40 AND HT®40 PARTS ARE FULLY INTERCHANGEABLE IN CASE OF NEED.

**Last update of this page: 11/04/2016. See Revision history for details.**

**THERMACUT®**  
 THE CUTTING COMPANY™

WWW.THERMACUT.CZ  
 TEL.: +420 556 423 418  
 SALES@THERMACUT.CZ

WWW.THERMACUT.DE  
 TEL.: +49 (0) 27 39 40 33 0  
 INFO@THERMACUT.DE

WWW.THERMACUT.COM  
 TEL.: 1-603-542-6715  
 CUSTOMERSERVICE@THERMACUT.COM

THERMACUT®, THE CUTTING COMPANY®, FHT-EX®, EX-TRAFIRE®, EX-TRACK®, EX-TRABEAM® AND EX-TRAFAME® ARE REGISTERED TRADEMARKS OF THERMACUT, K.S. AND MAY BE REGISTERED IN CZECH REPUBLIC AND/OR OTHER COUNTRIES. ALL OTHER TRADEMARKS ARE PROPERTIES OF THEIR RESPECTIVE OWNERS. THERMACUT IS NO WAY AFFILIATED WITH Hypertherm®.  
 MOST THERMACUT PARTS ARE MADE FOR OR BY AN IBC COMPANY. PARTS INDICATED WITH A OEM ARE ORIGINAL PARTS MANUFACTURED BY THE ABOVE NAMED MANUFACTURER AND ARE BEING RESOLD BY THERMACUT. THERMACUT RESERVES THE RIGHT TO SUBSTITUTE OEM PARTS IN PLACE OF THERMACUT PARTS.  
 VALID FROM NOVEMBER 2020 • PREVIOUS VERSION IS NO LONGER VALID. • © COPYRIGHT 2020 BY THERMACUT® CZECH REPUBLIC. ALL RIGHTS RESERVED.