

REPLACEMENT PARTS SUITABLE FOR ESAB®/L-TEC®

PT-31XL™

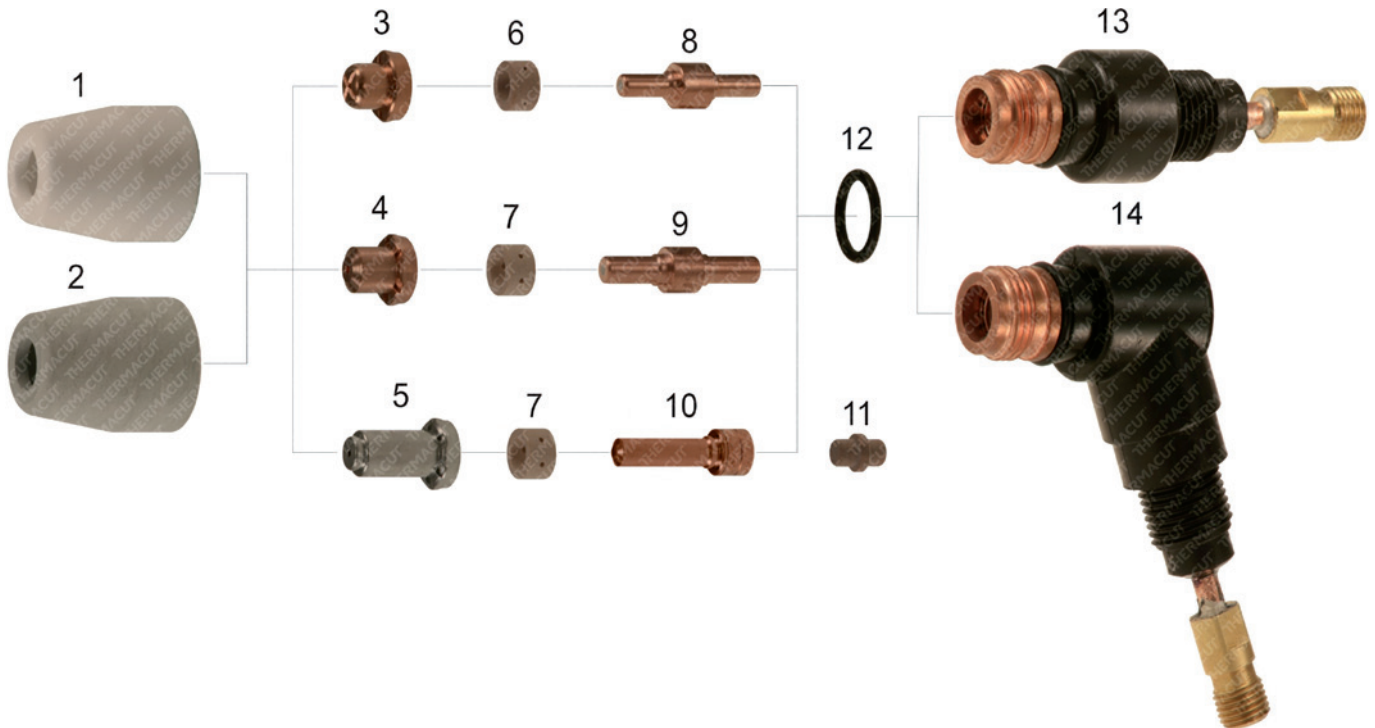

Item	Part No.	Ref. No.	Description	Std. Pkg.	Item	Part No.	Ref. No.	Description	Std. Pkg.
1.	T-0289	18204	Heat Shield	10	T-12916	0558000506		Swirl Baffle	5
2.	T-0290	20282	Heat Shield	1	8.	T-0295	18205	Electrode Standard	10
3.	T-0291	18866	Nozzle 30A	10	9.	T-0296	19683	Electrode Heavy Duty	10
4.	T-1297	20079	Nozzle 50A	10	10.	T-1173	20862	Electrode XT	10
5.	T-1174	20860	Nozzle XT 30-40A	10	#11.	T-1172#	20324	Plunger	5
	T-1176	20861	Nozzle XT 50A	10	12.	T-0357	950790	O-Ring	1
	T-1175	21008	Nozzle 35-40A	10	13.	T-0298	20073	Torch Body, Machine	1
6.	T-0293	18785	Swirl Baffle	10	14.	T-0297	20072	Torch Body 70°, Hand	1
7.	T-0294	20463	Swirl Baffle	5	NS	KT-1339	0558003183	PT-31XLPC™ Torch with Leads, 7,6m (25')	1

NON COMPATIBLE WITH THERMACUT TORCH, ONLY FOR OEM TORCH

Last update of this page: 31/07/2016. See Revision history for details.

THERMACUT®
THE CUTTING COMPANY

WWW.THERMACUT.CZ
TEL.: +420 556 423 418
SALES@THERMACUT.CZ

WWW.THERMACUT.DE
TEL.: +49 (0) 27 39 40 33 0
INFO@THERMACUT.DE

WWW.THERMACUT.COM
TEL.: 1-603-542-6715
CUSTOMERSERVICE@THERMACUT.COM

THERMACUT®, FHT-EX® AND EX-TRAFIRE® ARE REGISTERED TRADEMARKS OF THERMACUT, K. S. AND MAY BE REGISTERED IN CZECH REPUBLIC AND/OR OTHER COUNTRIES. ALL OTHER TRADEMARKS ARE PROPERTIES OF THEIR RESPECTIVE OWNERS. THERMACUT IS NO WAY AFFILIATED WITH ESAB®/L-TEC®. MOST THERMACUT PARTS ARE MADE FOR OR BY AN IBG COMPANY. PARTS INDICATED WITH A OEM ARE ORIGINAL PARTS MANUFACTURED BY THE ABOVE NAMED MANUFACTURER AND ARE BEING RESOLD BY THERMACUT. THERMACUT RESERVES THE RIGHT TO SUBSTITUTE OEM PARTS IN PLACE OF THERMACUT PARTS. VALID FROM JANUARY 2017 • PREVIOUS VERSION IS NO LONGER VALID. © COPYRIGHT 2017 BY THERMACUT® CZECH REPUBLIC. ALL RIGHTS RESERVED.