

REPLACEMENT PARTS SUITABLE FOR Hypertherm®

MAX®40
PAC®140/M

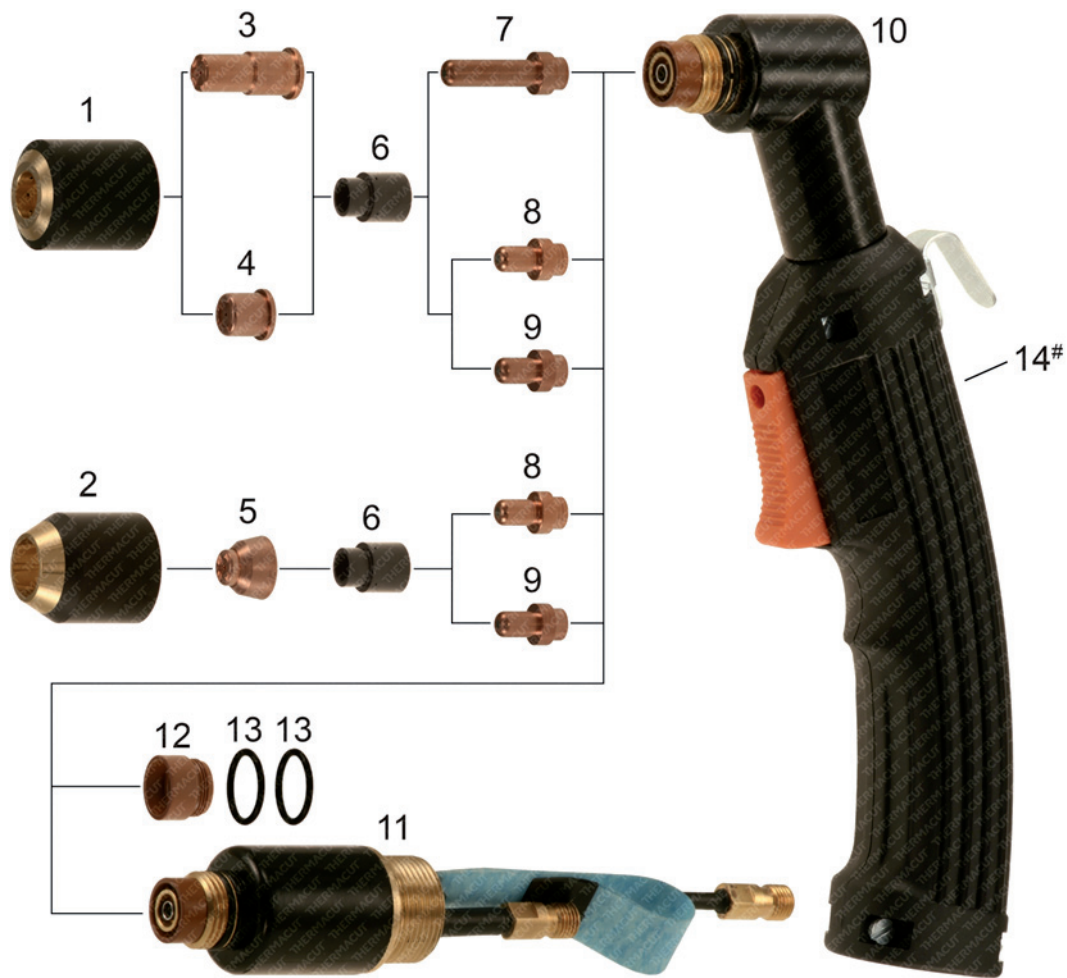

Item	Part No.	Ref. No.	Description	Std. Pkg.	Item	Part No.	Ref. No.	Description	Std. Pkg.
1.	T-0043	020104	Retaining Cap, Standard	1	9.	T-0052	020103	Electrode, Air	10
2.	T-0044	020200	Retaining Cap, Tapered	1	10.,14.	T-0055	020122	PAC®140 Hand Torch + Handle	1
3.	T-0050	020466	Nozzle, Extended	10	11.	T-0056	020114	PAC®140/M Machine Torch	1
4.	T-0045	020115	Nozzle 40A	10	12.	T-0095	020114-1	Front Insulator	1
	T-0046	020102	Nozzle 40A (HT®40)	10	13.	T-0038	044016	O-Ring	1
5.	T-0048	020197	Nozzle 40A, Tapered	10	#14.	T-1040#	9-5636-1	Handle	5
NS	T-0096	020340	Nozzle, Gouging	10	NS	KT-1229	K.PAC140H.5M	PAC®140/H Hand Torch with Lead 5m (16')	1
NS	T-0047	020131	Nozzle, Pipe Saddle (HT®40)	10	NS	KT-1210	057112	PAC®140/H Hand Torch with Lead 7,6m (25')	1
6.	T-0051	020101	Swirl Ring	2	NS	KT-1261	057113	PAC®140/H Hand Torch with Lead 15,2m (50')	1
7.	T-0054	020467	Electrode, Extended	5	NS	KT-1084	028290	PAC®140/M Cable Leads, Mach.15,2m (50')	1
8.	T-0053	020167	Electrode, N ₂	10				Different types of cable leads available on request	

ONLY FOR THERMACUT TORCH DESIGN

NS NOT SHOWN IN THE PICTURE

MAX®40 AND HT®40 PARTS ARE FULLY INTERCHANGEABLE IN CASE OF NEED.

Last update of this page: 11/04/2016. See Revision history for details.

THERMACUT®
THE CUTTING COMPANY

WWW.THERMACUT.CZ
TEL.: +420.556.423.418
SALES@THERMACUT.CZ

WWW.THERMACUT.DE
TEL.: +49 (0) 27 39 40 33 0
INFO@THERMACUT.DE

WWW.THERMACUT.COM
TEL.: 1-603-542-6715
CUSTOMERSERVICE@THERMACUT.COM

THERMACUT®, FHT-EX® AND EX-TRAFIRE® ARE REGISTERED TRADEMARKS OF THERMACUT, K. S. AND MAY BE REGISTERED IN CZECH REPUBLIC AND/OR OTHER COUNTRIES. ALL OTHER TRADEMARKS ARE PROPERTIES OF THEIR RESPECTIVE OWNERS. THERMACUT IS NO WAY AFFILIATED WITH Hypertherm®. MOST THERMACUT PARTS ARE MADE FOR OR BY AN IBG COMPANY. PARTS INDICATED WITH A OEM ARE ORIGINAL PARTS MANUFACTURED BY THE ABOVE NAMED MANUFACTURER AND ARE BEING RESOLD BY THERMACUT. THERMACUT RESERVES THE RIGHT TO SUBSTITUTE OEM PARTS IN PLACE OF THERMACUT PARTS. VALID FROM JANUARY 2017 • PREVIOUS VERSION IS NO LONGER VALID. • © COPYRIGHT 2017 BY THERMACUT® CZECH REPUBLIC. ALL RIGHTS RESERVED.