

# REPLACEMENT PARTS SUITABLE FOR Hypertherm®

MAX®100D  
PAC®160/E

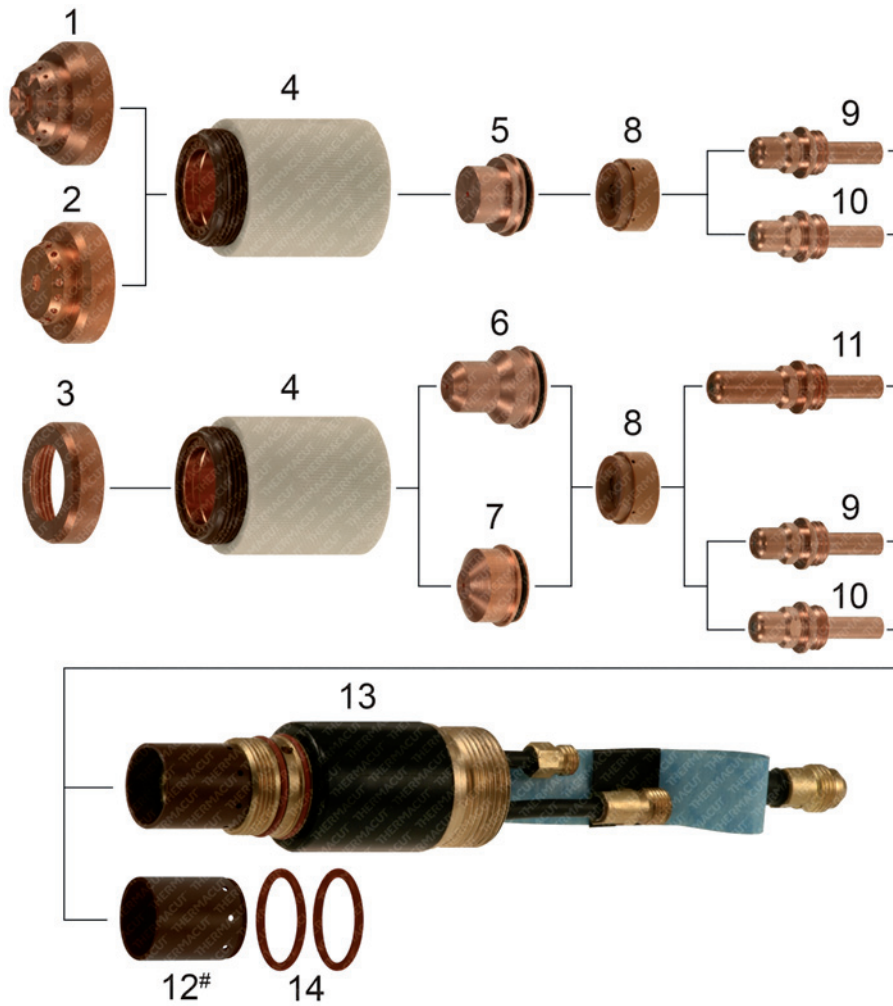

Item	Part No	Ref. No.	Description	Std. Pkg	Item	Part No.	Ref. No.	Description	Std. Pkg.
*1.	T-3885*	020335-UR	Shield, Hand, 100A	1	7.	T-1055	020922	Nozzle 60A, NonShielded	5
	T-0072	020335	Shield, Hand, 100A	1		T-1056	020921	Nozzle 30A, 40A, NonShielded	5
*2.	T-3884*	020334-UR	Shield, Machine, 100A	1	8.	T-1059	020706	Swirl Ring	2
	T-0071	020334	Shield, Machine, 100A	1	9.	T-8128	120433	Electrode 60A, 80A, 100A	5
	T-1041	020492	Shield Mach. 40A-MAX®100, 60A-MAX®100D	1		T-1063	020951	Electrode 30-40A	5
3.	T-0070	020333	Deflector	1	10.	T-0067	020193	Electrode 40A, 80A, 100A	5
4.	T-1049	020846	Retaining Cap, 100A	1		T-0066	020191	Electrode 80A, 100A	5
	T-1050	020756	Retaining Cap, 60A	1	11.	T-0098	020564	Electrode, Extended	5
5.	T-1053	020705	Nozzle 100A, Shielded	5	#12.	T-8113#	020713-4B	Insulator	1
	T-0838	120336	Nozzle 60A, Shielded	5	13.	T-1398	020713	PAC®160/E Machine Torch	1
	T-1054	020753	Nozzle	5	14.	T-0074	026018	O-Ring	1
6.	T-1052	020754 OEM	Nozzle 100A, Extended	5					

\* FULLY INTERCHANGEABLE WITH ORIGINAL PARTS, BUT DIFFERS FROM ORIGINAL DESIGN

# ONLY FOR THERMACUT TORCH DESIGN

**Last update of this page: 11/04/2016. See Revision history for details.**

**THERMACUT®**  
THE CUTTING COMPANY

WWW.THERMACUT.CZ  
TEL.: +420 556 423 418  
SALES@THERMACUT.CZ

WWW.THERMACUT.DE  
TEL.: +49 (0) 27 39 40 33 0  
INFO@THERMACUT.DE

WWW.THERMACUT.COM  
TEL.: 1-603-542-6715  
CUSTOMERSERVICE@THERMACUT.COM

THERMACUT®, FHT-EX® AND EX-TRAFIRE® ARE REGISTERED TRADEMARKS OF THERMACUT S. R. O. AND MAY BE REGISTERED IN CZECH REPUBLIC AND/OR OTHER COUNTRIES. ALL OTHER TRADEMARKS ARE PROPERTIES OF THEIR RESPECTIVE OWNERS. THERMACUT IS NO WAY AFFILIATED WITH Hypertherm®. MOST THERMACUT PARTS ARE MADE FOR OR BY AN IBG COMPANY. PARTS INDICATED WITH A OEM ARE ORIGINAL PARTS MANUFACTURED BY THE ABOVE NAMED MANUFACTURER AND ARE BEING RESOLD BY THERMACUT. THERMACUT RESERVES THE RIGHT TO SUBSTITUTE OEM PARTS IN PLACE OF THERMACUT PARTS. VALID FROM JUNE 2016 • PREVIOUS VERSION IS NO LONGER VALID. © COPYRIGHT 2016 BY THERMACUT® CZECH REPUBLIC. ALL RIGHTS RESERVED.